

STORAGE AND DISPOSAL

Do not contaminate water, food, or feed by storage or disposal.

PESTICIDE STORAGE: Keep this product in its tightly closed original container when not in use. Store in a cool, dry, well-ventilated area that is inaccessible to children and animals. For optimal long-term storage, do not store above 73° F (23° C). Store this product in a place away from strong bases, strong acids, sources of ignition and direct sunlight. During transport and field use, keep **In2Mix**® packages below 110° F (43° C) at all times by avoiding sunlight and heat, and using isolation packaging.

PESTICIDE DISPOSAL: Dispose of used gauze in a sanitary landfill, or by other procedures approved by state and local authorities. Dispose of used water with attractants by pouring out of **In2Mix**® trap onto the ground, and not near a water source. Prevent entry of used water into sewers, gutters, or drains, or any area where drainage to storm sewers, water bodies, or aquatic habitat can occur. Notify authorities if liquid enters sewers or public waters.

CONTAINER HANDLING: Completely empty **In2Mix**® package into the **In2Care**® trap by shaking and tapping sides and bottom to loosen clinging particles. When completely empty, dispose of empty package in trash or by other procedures approved by state and local authorities.

NOTICE: Buyer and user assume all risks and liability of use, storage and/or handling of this product not in accordance with the terms of this label.

PYRIPROXYFEN	GROUP	7C	INSECTICIDE
<i>Beauveria bassiana</i> Strain GHA	GROUP	UN	INSECTICIDE

Net Weight: 12.5 g (0.44 oz.)
25 packages x 0.5 g each (0.018 oz.)
EPA Reg. No.: 91720-1
EPA Est. No.: 91720-NLD-1

In2Mix®

For Use In The In2Care® Trap

For use to control *Aedes* species of Mosquitoes that may transmit Zika, Chikungunya, and Dengue Fever

**THIS PRODUCT IS NOT FOR SALE TO OR USE BY HOMEOWNERS
READ ALL LABEL DIRECTIONS COMPLETELY BEFORE USE**

SHAKE In2Mix® PACKAGE BEFORE USE

Active Ingredients:	% w/w
Pyriproxyfen (CAS No. 95737-68-1)	74.03%
<i>Beauveria bassiana</i> strain GHA* (CAS No. 63428-82-0)	10.00%
Other Ingredients	15.97%
Total	100.00%

* Contains not less than 4.5 X 10⁹ viable spores/gm.

KEEP OUT OF REACH OF CHILDREN

CAUTION

**SEE LABEL BOOKLET FOR ADDITIONAL
PRECAUTIONARY STATEMENTS AND COMPLETE
DIRECTIONS FOR USE**



Manufactured by: In2Care B.V. Marijkeweg 22, 6709 PG Wageningen, The Netherlands

HOW IT WORKS
In2Mix® powder contains a growth regulator and slow acting adulticide. The growth regulator kills the *Aedes* spp. larvae that emerge from eggs laid inside the trap prior to transforming into adults. This means that it is normal to see small living larvae in the trap that will eventually die. After laying eggs, the adult *Aedes* spp. mosquito is contaminated with the In2Mix® powder. When they fly out of the trap to lay more eggs elsewhere, they disseminate the growth regulator and kill larvae in breeding sites around the trap. The adulticide contained in the In2Mix® powder slowly kills adult *Aedes* spp. mosquitoes. Contaminated mosquitoes will die within a few days following exposure to In2Mix® powder. Therefore, dead adult mosquitoes may not be found in the trap.

- **DO NOT allow people or pets to contact the pesticide.**
- **FOR OUTDOOR USE ONLY.**
- **SHAKE In2Mix® PACKAGE BEFORE USE.**
- **READ ALL LABEL DIRECTIONS COMPLETELY BEFORE USE.**

It is a violation of Federal law to use this product in a manner inconsistent with its labeling.

DIRECTIONS FOR USE

This product is toxic to fish and aquatic invertebrates. Do not apply directly to areas where surface water is present or to intertidal areas below the mean high water mark. Do not contaminate water by cleaning of equipment or disposal of equipment washwaters. Application of this product is prohibited directly into sewers or drains, or to any area like a gutter where drainage to storm sewers, water bodies, or aquatic habitat can occur. Do not allow the product to enter any drain during or after application. This product is highly toxic and may be pathogenic to bees exposed to direct treatment on blooming crops or weeds. Do not apply this product or allow it to drift to blooming crops or weeds while bees are actively visiting the treatment area.

ENVIRONMENTAL HAZARDS

- Users should:
- Wash hands before eating, drinking, chewing gum, using tobacco, or using the toilet.
 - Remove clothing/PPE immediately if pesticide gets inside. Then wash thoroughly and put on clean clothing.
 - Remove PPE immediately after handling this product. Wash the outside of gloves before removing.
- As soon as possible, wash thoroughly and change into clean clothing.

USER SAFETY RECOMMENDATIONS

PRECAUTIONARY STATEMENTS HAZARD TO HUMAN AND DOMESTIC ANIMALS

Harmful if inhaled, swallowed, or absorbed through skin. Causes moderate eye irritation. Avoid breathing dust. Avoid contact with skin, eyes or clothing. Wash hands thoroughly with soap and water after handling and before eating, drinking, chewing gum, using tobacco or using the toilet. Repeated exposure to high concentrations of microbial proteins can cause allergic sensitization. Prolonged or frequently repeated skin contact may cause allergic reactions in some individuals. Remove and wash contaminated clothing before reuse. Obtain medical attention if irritation persists. Avoid contamination of food or feedstuffs.

PERSONAL PROTECTIVE EQUIPMENT (PPE)

- All applicators and handlers must wear:
- Long-sleeved shirt and long pants;
- Waterproof gloves; and
- Shoes plus socks
- In addition, all applicators and handlers must wear a NIOSH-approved particulate respirator with any N, R, or P filter (NIOSH approval number prefix TC-84A); or a NIOSH-approved powered air purifying respirator with an HE filter (NIOSH approval number prefix TC-21C).

Follow the manufacturer's instructions for cleaning/maintaining PPE. If no such instructions for washables exist, use detergent and hot water. Keep and wash PPE separately from other laundry.

FIRST AID

FIRST AID	
If Inhaled	Move person to fresh air. If person is not breathing, call 911 or an ambulance, then give artificial respiration, preferably by mouth-to-mouth, if possible. Call a poison control center or doctor for further treatment advice.
If Swallowed	Call a poison control center or doctor immediately for treatment advice. Have a person sip a glass of water if able to swallow. Do not induce vomiting unless told to do so by the poison control center or doctor. Do not give anything by mouth to an unconscious person.
If on Skin	Take off contaminated clothing. Rinse skin immediately with plenty of water for 15-20 minutes. Call a poison control center or doctor for treatment advice.
If in Eyes	Hold eye open and rinse slowly and gently with water for 15-20 minutes. Remove contact lenses, if present, after the first 5 minutes, then continue rinsing eye. Call a poison control center or doctor for treatment advice.
HOT LINE NUMBER	Have the product container or label with you when calling a poison control center or doctor or going for treatment. For non-emergency general information on this pesticide product (including health concerns or pesticide incidents), call the poison control center at 1-800-222-1222 after 12:00 P.M. PST on weekdays and during the weekend.

HOW TO ASSEMBLE



STEP 1:

1. Fill the base of the trap with 5 quarts (4.7 liters) of clean tap water

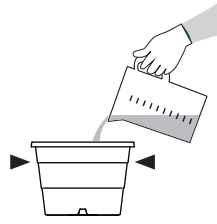

2. **SHAKE THE In2Mix® PACKAGE THOROUGHLY.** Open by tearing at the notches and gently take out the powdercoated gauze strip.



3. Empty the remaining contents (powder and odor tablets) of the In2Mix® package into the water in the base of the trap. Do not allow the gauze to get wet.



STEP 2:

1. To attach the In2Mix® gauze strip to the floater, slide the loop at the end of the gauze over the pin as shown. Try not to touch the gauze extensively to avoid removal of the active powders.

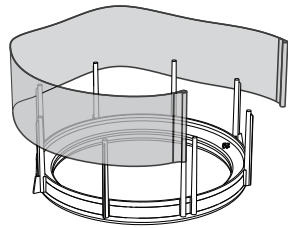

2. Wrap the gauze around the floater and slide the other gauze loop on the last pin as shown. Work your way around moving the gauze down at each pin.

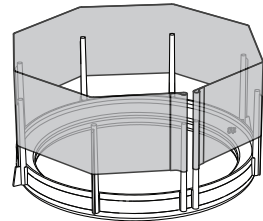

3. Push the gauze down the pins until it will go no further (where the bottom of the pin hits the circular rib). The rib will prevent the gauze from sliding down too far.

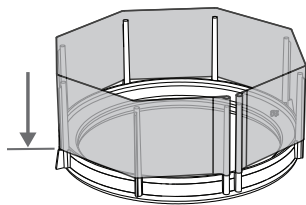

STEP 3:

1. Place the assembled floater inside the base of the trap by gently placing it over the central tube flat onto the water.

Do not allow the gauze to get wet as water will degrade the powder.

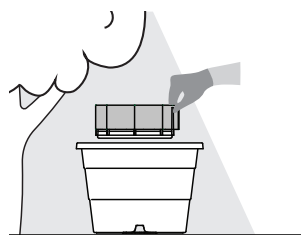

2. Place the lid on the central tube, push it down and turn it clockwise.

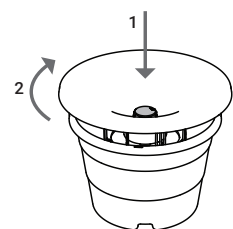

3. Turn the time indicator to the number of the current month as a service reminder. Use one In2Mix® package per trap every 4 weeks when adult mosquitoes are active.

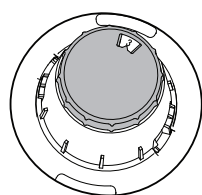

WHERE TO PLACE

1. Place the water-filled In2Care® trap outside on the ground in a level, shaded location near human habitation. Avoid locations with direct sunlight; continuous shade is needed.

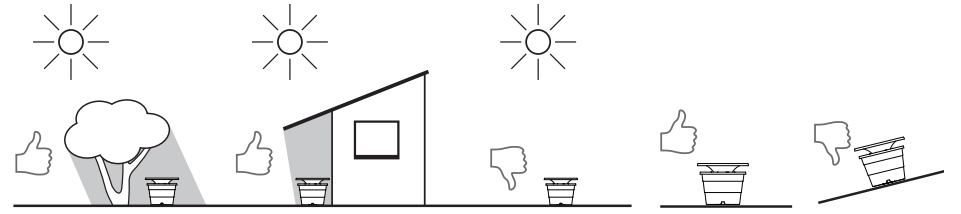

For best results, remove and/or empty artificial water containers (e.g., flower pots, plastic cups, car tires, etc.) and natural breeding sites (e.g., puddles, tree holes, etc.). Larger water bodies that cannot be removed or emptied should be (frequently) treated with appropriate mosquito larvicides.

2. For optimal coverage, place at least 1 In2Care® trap every 4,300 sq. feet (400 sq. meters), or at least 10 traps per acre in areas where Aedes mosquitoes breeding can be expected. Do not exceed 15 traps per acre.



3. When necessary, stability can be improved by securing the trap to the ground with the following:

- a. Wire bracket, available separately from the distributor, which snaps onto the base. The wire bracket can be screwed onto a surface or fixed with a ground pin.
- b. Zip tie (not included). Zip Tie spec: width: 4.8mm length: 600mm. The loop can be tied to a pin or hook.
- c. The base may also be attached to a pole, shrub or tree by using zip ties or a small rope tied through the holes in the rim of the base.

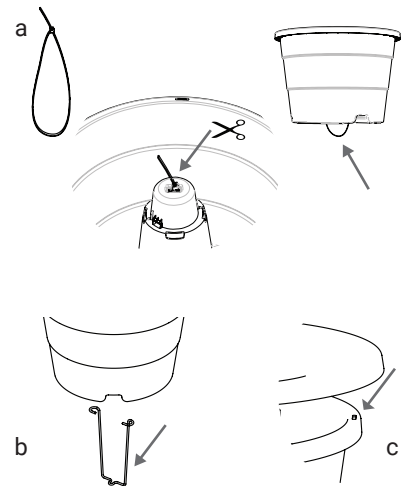

NOTE: Aedes spp. mosquitoes can have very specific breeding preferences within certain locations.

Check for the presence of live and dead mosquito larvae inside the traps every 4 weeks. When a trap continuously has zero or much fewer larvae when compared to other nearby traps, the unattractive trap should be relocated to another nearby shaded location.

MAINTAINING THE TRAP

1. Re-visit each In2Care® trap every 4 weeks. Remove the lid by turning it counterclockwise until it stops and lift up.

NOTE: In hot and dry climates the water level must be checked more frequently. Add water as necessary to maintain the correct amount (5 quarts; 4.7 liters) in the base of the trap.

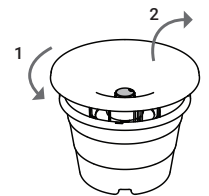

2. Take out the floater and dispose of the used gauze and water as indicated in the STORAGE AND DISPOSAL section of this label.

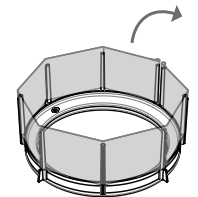

3. Remove leaves or other debris that may have fallen into the base of the trap. Refill the trap with 5 quarts (4.7 liters) of clean tap water.

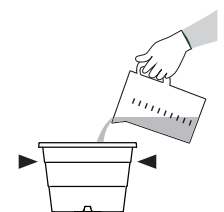

4. Take a new In2Mix® package and repeat Steps 1 & 2 in HOW TO ASSEMBLE.

